

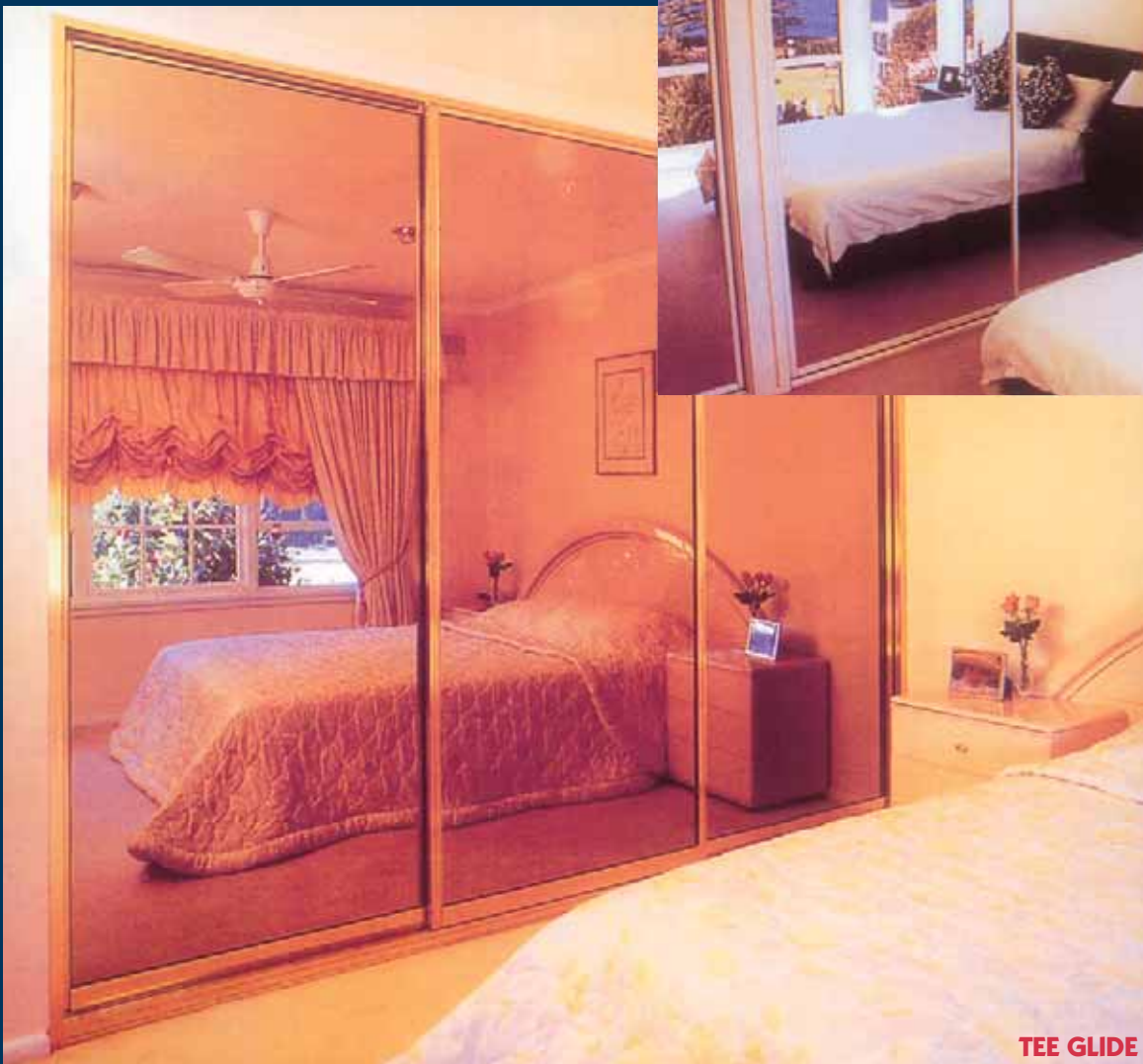

VEE GLIDE

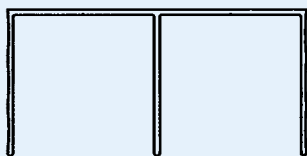

TEE GLIDE



AS9531
SHALLOW HEAD

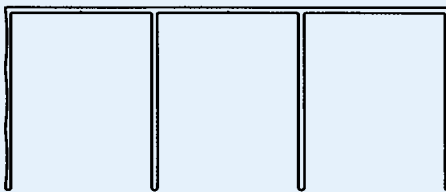

AS10427
TRIPLE HEAD

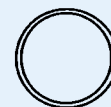

RT25.41.22
HANGING RAIL

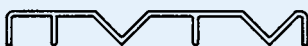

AS9533
SILL

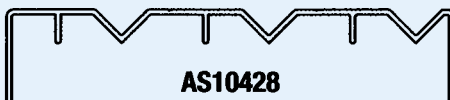

AS10428
TRIPLE SILL



AS50187
HANGING RAIL OVAL

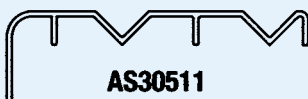

AS30511
LIPPED SILL

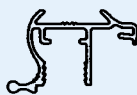

UN00804
STILE



AS50230
SASH RAIL

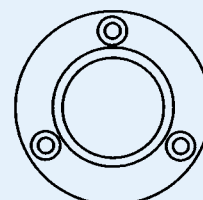

WVG120WH
BRACKET SUIT
ROUND RAIL

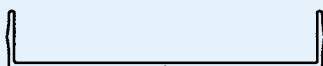

AS9532
CHANNEL JAMB

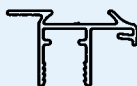

UN00805
LIPPED STILE
(FRAMELESS)



AS31737
LIPPED SASH RAIL
(FRAMELESS)

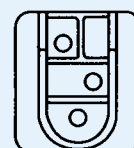

WVG130WH
BRACKET SUIT
OVAL RAIL

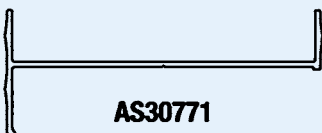

AS30771
COVER JAMB



AS6577
WALL CHANNEL



A32201.6
ANGLE

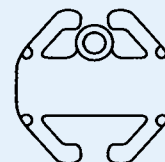

WVG100
HEAD GUIDE

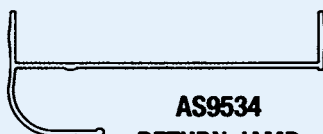

AS9534
RETURN JAMB

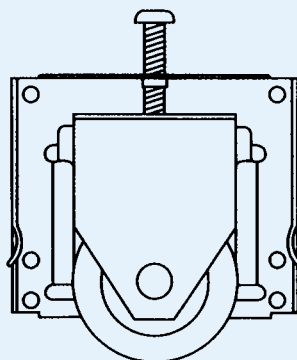

WVG300
DOOR ROLLER



WA210BK
WEDGE SUIT
9mm BOARD



WA220BK
WEDGE SUIT
10mm BOARD



WA200(COLOUR)150
GLAZING CHANNEL
SUIT 4mm MIRROR



WVG200(COLOUR)200
STILE BUFFER STRIP

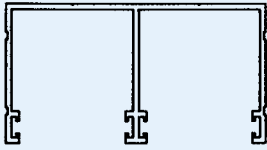

AS7631
HEAD

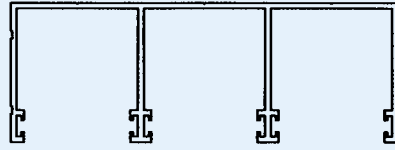

AS8096
TRIPLE TRACK HEAD

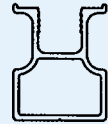

AS882
GRIP STILE

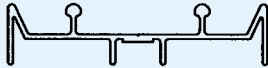

AS7632
SILL

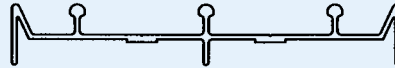

AS8097
TRIPLE TRACK SILL

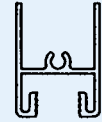

AS7634
TOP RAIL



AS7630
RETURN JAMB



SP2949
TRIPLE TRACK JAMB

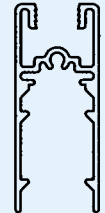

AS7633
BOTTOM RAIL



SP3165
JAMB



SP3409
ROUND EDGE JAMB

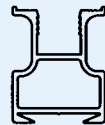

AS31211
GRIP STILE



AS6577
WALL CHANNEL

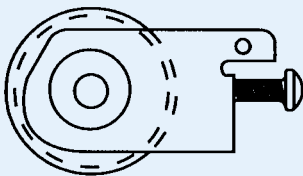

WTG300MI
DOOR ROLLER



WTG100BK
WOOL PILE STRIP



WA200CL
GLAZING CHANNEL
SUIT 4mm MIRROR



305-60(COLOUR)
STILE BUFFER STRIP



WTG210CL
GLAZING CHANNEL
SUIT 9mm BOARD



WA210BK
WEDGE SUIT
9mm BOARD



WA220BK
WEDGE SUIT
10mm BOARD

REGISTERED DESIGN:

Unique features of the Ullrich Tee Glide wardrobe door system are protected by Australian Design Registration No 96859.



Phone for your nearest
ULLRICH ALUMINIUM SALES CENTRE

AUSTRALIA - 1 300 650 075

NEW ZEALAND - 0800 500 338

- ALUMINIUM EXTRUSIONS
- ROLLED PRODUCTS
- FASTENINGS
- LADDERS
- SCAFFOLDS
- ULLTRACLAD CLADDING
- WINTEC WINDOWS & DOORS
- BUILDING PRODUCTS
- DECORATIVE METALS
- TEKNA MACHINERY

Map key:

- + MANUFACTURING
- SALES & DISTRIBUTION
- * EXTRUSION PLANT

Representative and franchised operations throughout the South Pacific

ULLRICH ALUMINIUM PTY LTD
PO Box 2182 Smithfield NSW 2164
185-187 Woodpark Rd Smithfield Australia
Tel +61 2 8787 7400 Fax +61 2 9725 2784
ullrich@ullrich.com.au www.ullrich.com.au

ULLRICH ALUMINIUM CO LTD
PO Box 98 843 SAMC
Manukau City 2240 New Zealand
Tel +64 9 262 6262 Fax +64 9 262 6265
alkalum@uacl.co.nz www.ullrich-aluminium.co.nz