

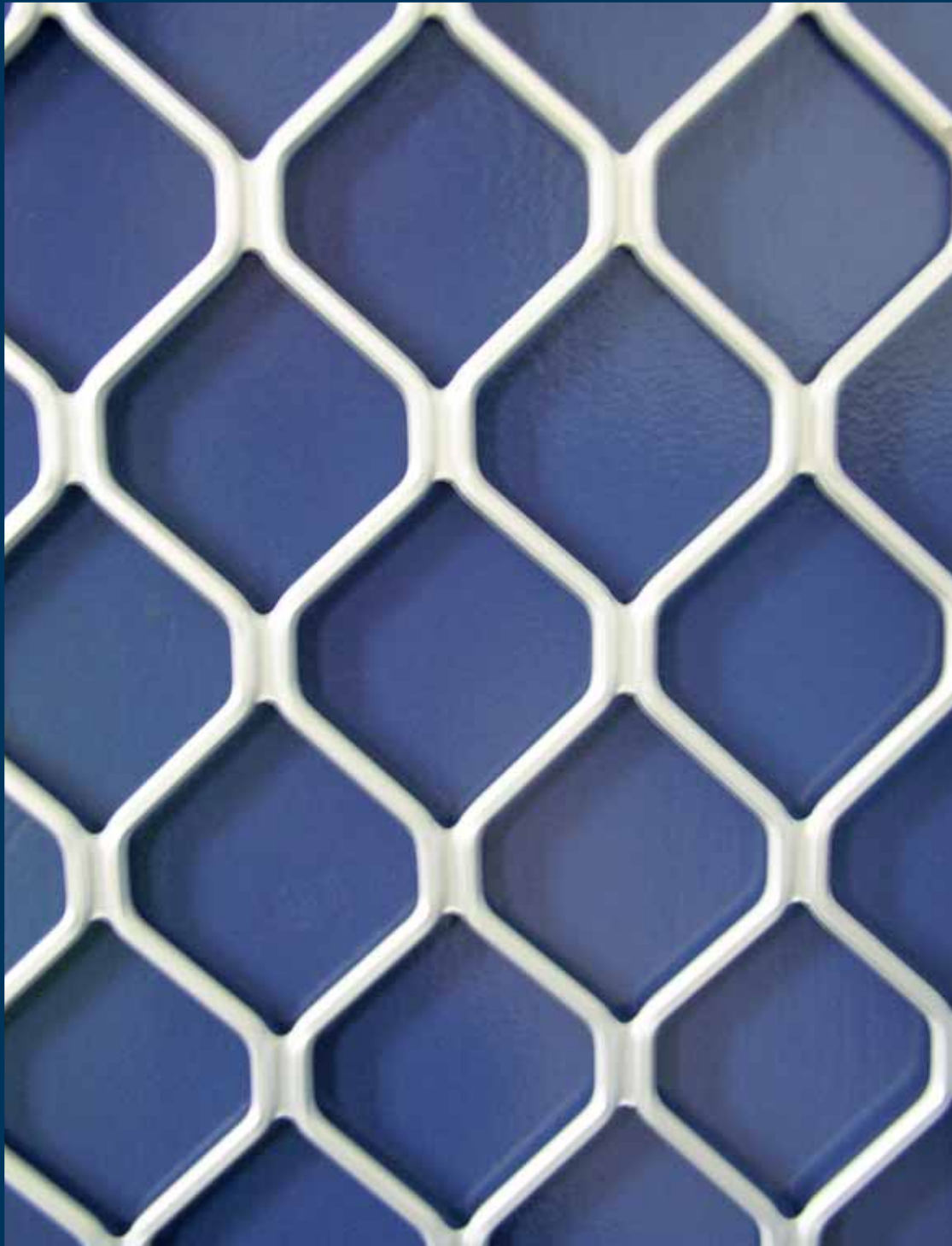

ULLRICH
ALUMINIUM

SECURITY DOORS & RELATED PRODUCTS



***Designed to protect,
built to last!***

June 08



SECURITY DOORS AND WINDOWS

The Ullrich Security Doors and Window System is designed for application to domestic and commercial building to provide an extra barrier against unwanted intrusion, trespass, burglary and home invasion, while allowing unrestricted airflow and vision outdoors.

The system comprises a complete range of extrusions, fittings and accessories ready for custom-fitting to individual specifications and design requirements.

The finished installation is lightweight for ease of use, yet sturdy and secure. Anodised or baked enamel coatings in a range of colours provide an attractive, fashionable finish.

Aluminium-alloy manufacturing materials are specially selected for extra durability, toughness and tamper resistance. Heavy duty 7mm Diamond Pattern grille panels exceed the sheer load test and specification requirements of ANZS2803 and are suitable for inclusion in door framing manufactured and tested to this standard.



“G007” SPECIFICATION

- 7mm Security Mesh (ASNZ 2803)
- 10 year guarantee
- Opening size – 67mm x 84mm
- Cord dimension – 7mm x 5.8mm
- Web thickness – 2mm
- Alloy 6063



EXTRUSION PROFILE (not to scale)

PART NUMBER

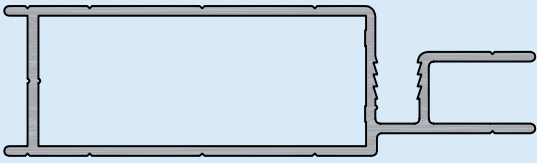

SP616
SECURITY DOOR FRAME
kg/m 0.574
ALLOY 6063 T5 (suit STAKE626)

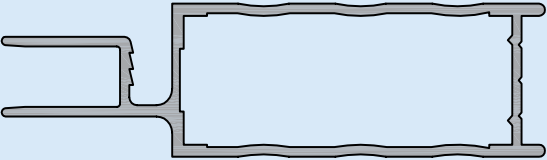

MKK965
MEDIUM DOOR FRAME
kg/m 0.595
ALLOY 6063 T5 (suit STAKE K965)



AS8830
FLAT INTERLOCK
kg/m 0.121
ALLOY 6063 T5

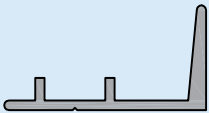

AS8825
FEMALE INTERLOCK
kg/m 0.156
ALLOY 6063 T5

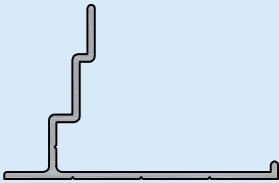

ALCN8138
TOP TRACK COVER
kg/m 0.284
ALLOY 6060 T5

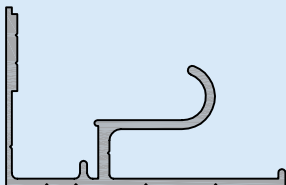

ALCN8137
TOP TRACK
kg/m 0.505
ALLOY 6060 T5

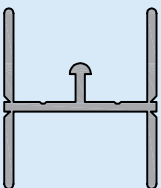

SP2685
SLIDING DOOR TRACK
kg/m 0.295
ALLOY 6060 T5

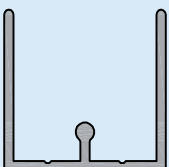

AS21280
SLIDING CHANNEL TRACK
kg/m 0.324
ALLOY 6060 T5

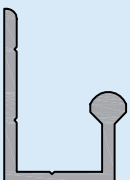

OAC126
J TRACK
kg/m 0.211
ALLOY 6060 T5

EXTRUSION PROFILE (not to scale)

PART NUMBER



OAC121
NIB TRACK
kg/m 0.097
ALLOY 6060 T5

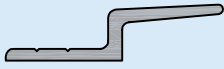

AS8827
EXTENDED OFFSET INTERLOCK
kg/m 0.105
ALLOY 6063 T5

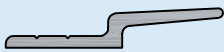

AS8826
SMALL OFFSET INTERLOCK
kg/m 0.125
ALLOY 6063 T5

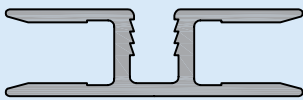

ALCL6715
MIDRAIL SECTION
kg/m 0.391
ALLOY 6063 T5

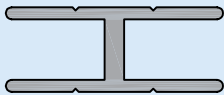

AS5741
H SECTION
kg/m 0.276
ALLOY 6063 T5

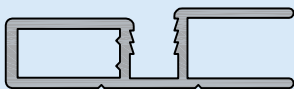

AS50324
SECURITY WINDOW FRAME
kg/m 0.308
ALLOY 6060 T5 (suit STAKE50324)

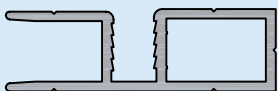

SP539
SECURITY WINDOW FRAME
kg/m 0.287
ALLOY 6063 T5 (suit STAKE539)



OAC004
FLY SCREEN CROSS BRACE
kg/m 0.265
ALLOY 6060 T5



EF229
EXTRUDED FLYFRAME
kg/m 0.128 Size: 23 X 9
ALLOY 6063 T5 (suit STAKE EFF229)

EXTRUSION PROFILE (not to scale)

PART NUMBER

**EF2511**

EXTRUDED FLYFRAME

kg/m 0.148 Size: 26 X 11

ALLOY 6063 T5 (suit STAKE EFF2511)

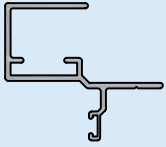
**AS8321**

SHORT LEG JAMB ADAPTOR

kg/m 0.412

ALLOY 6063 T5

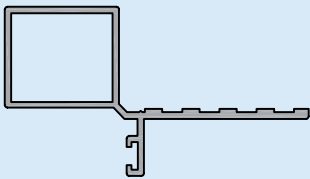
**ALCN9373**

LONG LEG JAMB ADAPTOR

kg/m 0.511

ALLOY 6060 T5

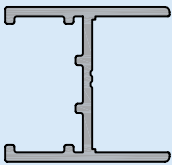
**JA140-031**

SH RECEIVER

kg/m 0.332

ALLOY 6063 T5

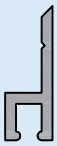
**AS8823**

BUG STRIP

kg/m 0.092

ALLOY 6063 T5 (suit Bug Strip SCHP13B)

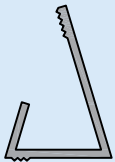
**AM602DVAJBEAD**

J FIXING BEAD

kg/m NIL

PLASTIC (suit Super mesh)

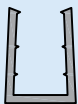
**ARCAP2.9**

ANTI RATTLE CAP

kg/m 0.092

PLASTIC

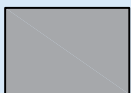
**SBEAD2.1PSBK**

STOP BEAD

kg/m NIL

PLASTIC

EXTRUSION PROFILE (not to scale)

PART NUMBER

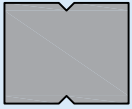
**SBead3PSBK**

STOP BEAD

kg/m NIL

PLASTIC

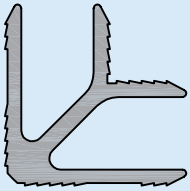
**STAKE 50132**

STAKING ANGLE

kg/m 4.142

ALLOY 6063 T5 (suit Frame AE6463)

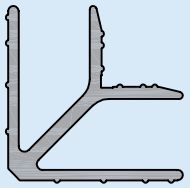
**STAKE K965**

STAKING ANGLE

kg/m 3.509

ALLOY 6060 T5 (suit Frame MKK965)

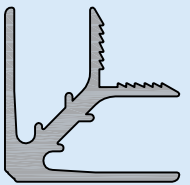
**STAKE 626**

STAKING ANGLE

kg/m 3.802

ALLOY 6060 T5 (suit Frame SP616)

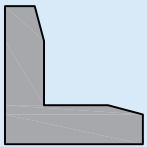
**STAKE 539**

STAKING ANGLE

kg/m 2.490

ALLOY 6060 T5 (suit Frame SP539)

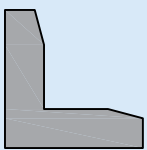
**STAKE 50324**

STAKING ANGLE

kg/m 2.460

ALLOY 6060 T5 (suit Frame AS50234)

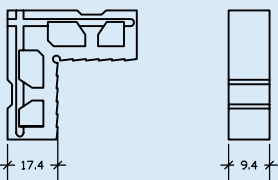
**STAKE EFF229**

STAKING ANGLE

kg/m NIL

PLASTIC (suit Frame EF229)

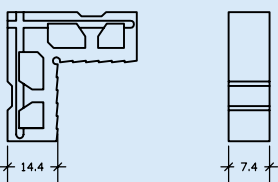
**STAKE 22511**

STAKING ANGLE

kg/m NIL

PLASTIC (black) (suit Frame EF2511)

DOOR & WINDOW ACCESSORIES

DISCRPTION

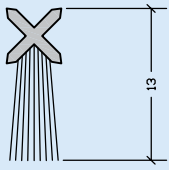

SCHPS13B
SCHLEGEL DOOR SEAL
kg/m NIL
(Black)

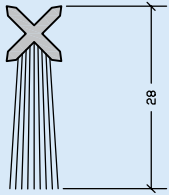

SCHPS28B
SCHLEGEL INSECT SEAL
kg/m NIL
(Black)

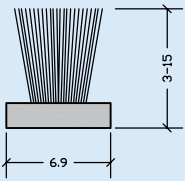

SCHPB6953-3B
SCHLEGEL WOOL PILE
kg/m NIL
(Black) (suit Frame AS50234)

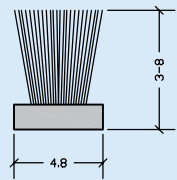

SCHPB4853-B/M
SCHLEGEL WEATHER SEAL
kg/m NIL
(Black) (suit Frame AS8321)



SPL4BK/300
SPL4.7BK/300
SPL5BK/300
SPL5.3BK/300
SPL5.7BK/300
SPL6BK/300
SPL6.3BK/300
SPL7BK/300
FLY SCREEN SPLINE (black)



FT4031
SPLINE TOOL

DOOR & WINDOW ACCESSORIES

DISCRPTION



WH844404
TASMAN ANTNI JEMMEY KIT



WH841400
DISC CYLINDER K.D
(suit Tasman / Flinders / 3PT)



DR227
SECURITY DOOR CARRIAGE

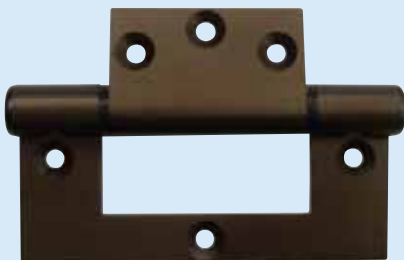

WH831417
TRIO STEEL SECURITY HINGE

DOOR & WINDOW ACCESSORIES

DISCRIPTION



WH810517
HINGE SCREEN DOOR CLOSE MKII



OAC021
PVC SWIVEL CLIP FLUSH



OAC022
PVC SWIVEL CLIP EXTENDED

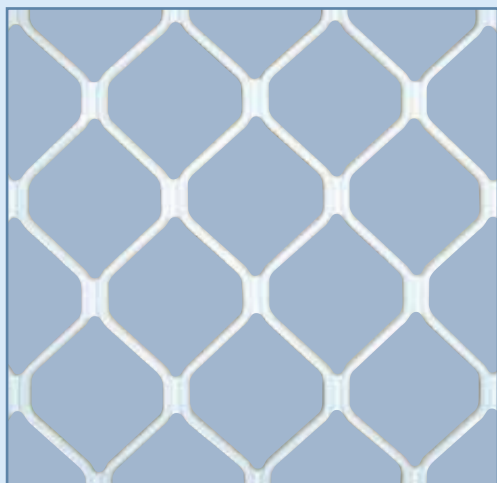

G007
SECURITY GRILLE

Size

750 x 2450mm	920 x 3050mm
750 x 2050mm	920 x 6150mm
750 x 3050mm	1250 x 2450mm
750 x 6150mm	1250 x 2050mm
835 x 2050mm	1250 x 3050mm
835 x 6150mm	1250 x 6150mm
920 x 2450mm	1070 x 6150mm
920 x 2050mm	

DOOR & WINDOW ACCESSORIES

DISCRIPTION



WH820117
SCREEN DOOR A LATCH



WH801202
TASMAN MKIII
HINGE SECURITY LOCK

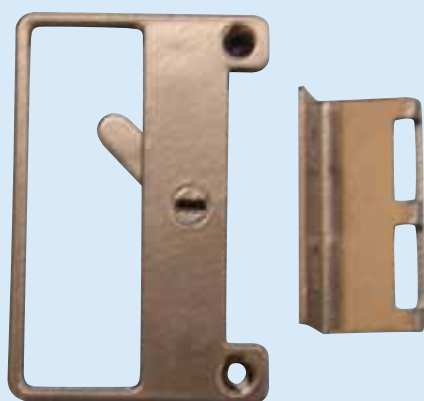

WH821317
BASS SLIDING SCREEN DOOR
CATCH STRIKER



WH865317
LEICHARDT SSD LOCK

ULLRICH INSERT MESH: PRODUCT INFORMATION

COMMERCIAL APPLICATIONS

For doors, windows and partitions in workplaces, storage areas and public buildings, where intrusion of insects is detrimental to comfort and hygiene and where natural airflow is desirable:

- Kitchens and food preparation areas
- Garden restaurants, patio bars and cafés
- Hotel and motel dining and accommodation rooms
- Factory cafeterias
- Hospitals and medical facilities
- Food processing plants and storage areas
- Food retail outlets
- Roll curtains for tent manufacturing (fibreglass mesh)

DOMESTIC APPLICATIONS

All dwelling apertures or partitions where intrusion of insects is detrimental to living comfort and hygiene, and where natural airflow is desirable:

- Main entrances
- Kitchens
- Dining rooms
- Living rooms and bedrooms
- Breeze-ways
- Conservatories
- Summer houses
- Covered decks and patios
- Pergola walls

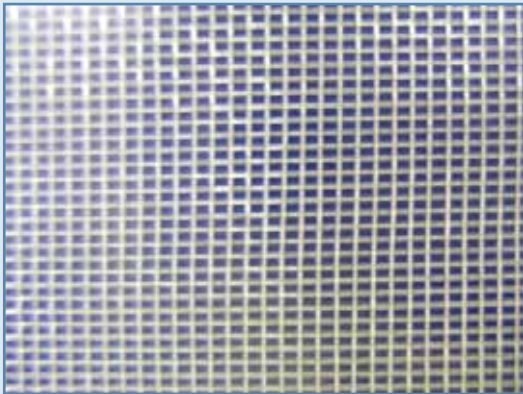

ALUMINIUM



FIBREGLASS

MATERIALS	COLOURS	CODE	MESH WIDTH (all mesh 18 x 16)
Aluminium	Black / Charcoal	MAS610BK30	610mm
		MAS760BK30	760mm
		MAS810BK30	810mm
		MAS910BK30	910mm
		MAS1220BK30	1220mm
		MAS1520BK30	1520mm
		MAS1830BK30	1830mm
Fibreglass	Black / Charcoal	MFS610BK50	610mm
		MFS760BK50	760mm
		MFS810BK50	810mm
		MFS910BK50	910mm
		MFS1070BK50	1070mm
		MFS1220BK50	1220mm
		MFS1520BK50	1520mm
		MFS1830BK50	1830mm
		MFS2140BK50	2140mm



Phone for your nearest
ULLRICH ALUMINIUM SALES CENTRE

AUSTRALIA - 1300 650 075

NEW ZEALAND - 0800 500 338

- ALUMINIUM EXTRUSIONS
- ROLLED PRODUCTS
- FASTENINGS
- LADDERS
- SCAFFOLDS
- ULLTRACLAD CLADDING
- WINTEC WINDOWS & DOORS
- BUILDING PRODUCTS
- DECORATIVE METALS
- TEKNA MACHINERY

Representative and franchised operations throughout the South Pacific

ULLRICH ALUMINIUM PTY LTD
 PO Box 2182 Smithfield NSW 2164
 185-187 Woodpark Rd Smithfield Australia
 Tel +61 2 8787 7400 Fax +61 2 9725 2784
 ullrich@ullrich.com.au www.ullrich.com.au

ULLRICH ALUMINIUM CO LTD
 PO Box 98 843 SAMC
 Manukau City 2240 New Zealand
 Tel +64 9 262 6262 Fax +64 9 262 6265
 alkalum@uacl.co.nz www.ullrich-aluminium.co.nz